

FACT SHEET

Location

Often described as 'Australia's Galapagos', Kangaroo Island is known for its prolific wildlife and natural beauty, offering a rich concentration of iconic Australian experiences in a compact area. Located off the coast of South Australia's Fleurieu Peninsula, Kangaroo Island (or 'KI' as the locals call it), is celebrated for its pristine natural environment, stunning coastal landscapes, abundant natural wildlife and artisan food and produce. At 155km in length and about 4500 square kilometres in area, KI is Australia's third-largest island, just 15km from the mainland. Native Australian animals including kangaroos, koalas, wallabies and echidnas can all be found in abundance, while marine mammals such as sea lions, seals, whales and dolphins make their home in surrounding waters. With twenty-one national and conservation parks, Kangaroo Island is widely known as a 'zoo without fences'.

Climate

A year-round destination, Kangaroo Island's climate is as dynamic as the scenery – from season to season the island yields fresh perspectives. The Mediterranean climate produces warm summers and temperate winters. Daytime temperatures range from 25-35°C in summer (Dec-Feb) to 14-18°C in winter (Jun-Aug).

Accommodation

Sensitively designed, Southern Ocean Lodge treads lightly on its surrounds yet still allows an intimate connection with the landscape. Each of its twenty-one suites offer sweeping ocean views and provide a luxury refuge from which to enjoy the constantly changing scenery. Signature design elements such as limestone floors and recycled spotted gum feature walls - as well as contemporary bespoke furnishings and artworks commissioned from local artisans - create a meaningful sense of place.

All suites feature generous king sleeping area with bespoke 'Baillie Bed', comfortable lounge, spacious glass-walled bathroom and private outdoor terrace. Other features include walk-in robe, complimentary in-suite bar, optional climate control, heated floors, wireless internet (limited bandwidth), music system, premium amenities, safe and telephone. Bathrobes, slippers, hairdryer and backpacks are provided along with twice-daily housekeeping and signature evening turndown service.



Flinders Suite (11) 65m²

Flinders Suites feature floor to ceiling glass to embrace uninterrupted views, king or twin beds, walk-in robe, sunken lounge and ensuite bathroom with oversized rain shower. An outdoor terrace with day bed invites.

Capacity: 2 adults in existing bedding / max capacity 2 persons.



Remarkable Suite (2) 120m²

Aptly named, the Remarkable Suite features a king bedroom with walk-in robe, separate living area warmed by an open fire and premium entertainment

system. A handmade timber bathtub overlooking the Southern Ocean defines the ensuite bathroom. Revel in the landscape on an expansive terrace with day lounge and private spa bath.

Capacity: 2 adults in existing bedding / max capacity 3 persons with rollaway.



Ocean Retreat (5) 75m²

Generously spacious, Ocean Retreats offer king bedding, lounge with feature fireplace, ensuite with freestanding tub and terrace with day bed.

Capacity: 2 adults in existing bedding / max capacity 3 persons with rollaway.

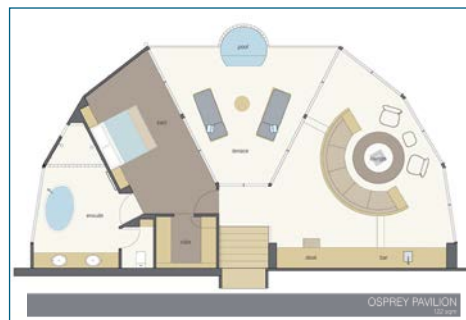

Osprey Pavilion (1) in excess of 120m²

The Osprey Pavilion showcases contemporary luxury and style while at the same time embracing its rarefied location. A unique curved floor plan features

a magnificent lounge centred around an open fire with custom furnishings, original artworks, premium in-suite bar and entertainment system. The king bedroom and walk-in robe lead to the open bathroom with hand sculptured granite bath and deluxe rain shower. An awe-inspiring outdoor terrace with private plunge spa completes the personal nature-meets-luxury experience.

Capacity: 2 adults in existing bedding / max capacity 3 persons with rollaway.



Ocean Premium (2) 120m²

Ocean Premium suites feature two bedrooms and two bathrooms (master with deep tub), linked by a central lounge area with fireplace and entertainment

system. An outdoor terrace and daybed provides a step into the landscape. Perfect for friends and couples travelling together and families.

Capacity: 4 adults OR 2 adults + 2 children in existing bedding / max capacity 5 persons with rollaway.

Check in/out Times

Check in 2pm / Check out 10.30am.

Restaurant & Bar

Dining at Southern Ocean Lodge is an experience in itself, capitalising on Kangaroo Island's rapidly developing status as a haven for artisan growers and food producers. The Lodge chefs work closely with island providers to source fine seasonal produce and create innovative contemporary menus. The spectacular panorama of Hanson Bay provides a dramatic backdrop for dining, while an open bar and well-stocked cellar offer a superb collection of exclusively South Australian fine wines. *Rates include full gourmet breakfast, light lunch, 4-course dinner with inspired daily menu and all beverages (cellarmasters list additional).*

The Great Room

At the heart of the Lodge is the magnificent Great Room, a breath-taking space framing remarkable views of the rugged coastline. It provides a stylish area in which to relax, read, socialise or reflect on the surrounds, while an adjoining outdoor terrace and heated plunge pool allow the opportunity to enjoy the pure ocean air and uninterrupted views from outside.

Baudin Lounge

A quiet space to read a book, watch a movie, enjoy a nature presentation or challenge a friend to a board game! Featuring a comprehensive reference library, interpretive display, movie and game library, the lounge can also be used for intimate meetings and events. *Capacity: 20 boardroom / 40 theatre style*

Experiences & Adventures

Central to a stay at Southern Ocean Lodge is a tailored offering of signature experiences, each providing an authentic connection with the island's natural landscapes, wildlife, scenery and lifestyle. A personalised itinerary is created for each guest on arrival offering guided walks, an excursion to the landmark Remarkable Rocks, a chance to encounter sea lions at Seal Bay and sunset canapés served among the wild kangaroos. *Rates include Signature Experiences; an optional menu of Bespoke Experiences and excellent private charters is also available (additional charges apply).*

Southern Spa

Reached by a short journey along the boardwalk among native mallee, the satellite Southern Spa appears above sheer limestone cliffs, offering sweeping coastal views stretching towards the imagined Antarctic. A signature menu of treatments features the Australian made LI'TYA spa care range complemented with Kangaroo Island's own natural beauty products. Three treatment rooms, a steam room and relaxation lounge offer guests a serene and indulgent retreat, perfect for soaking in the moment.

Services

Reception and boutique, business lounge, wireless internet (limited bandwidth), DVD, CD and reference library, daily laundry service (no dry cleaning) and postal service. Mobile/cell reception is limited to Telstra and affiliated carriers on Kangaroo Island. All major credit cards are accepted at the Lodge.

Access

Located at Hanson Bay on the Island's south-west coast, the Lodge is a 50 or 90 minute drive from the airport or ferry terminal respectively. [Air Regional Express](#) (Rex) provide regular daily flights (30 mins) from Adelaide (ADL) to Kangaroo Island – Kingscote (KGC). [QantasLink](#) offer direct flights to Kingscote from Adelaide (35 mins) on selected days and a seasonal flight from Melbourne (MEL) (125 mins) commencing December 2017. A 15kg luggage limit per person applies for Rex and 23kg for QantasLink; any excess may be uplifted or stored at Adelaide Airport for a nominal fee. For those guests travelling between Southern Ocean Lodge and sister property [Longitude 131°](#) in the Northern Territory, Qantas operate an excellent daily service from Ayers Rock (AYQ) via Alice Springs (ASP) to Adelaide (ADL) with air connections to Kingscote (KGC) Kangaroo Island via [Regional Express](#). To maximise your experience of each destination and for best air connections, sequencing a stay at Longitude 131° prior to Southern Ocean Lodge is recommended. [Charter Flights](#) Private charter flights are available from Adelaide to Kingscote. Flights can be arranged to/from other cities on application. [Ferry SeaLink](#) operate regular 45 minute ferry transfers between Cape Jervis on the mainland and Penneshaw on Kangaroo Island. Cape Jervis is a picturesque two hour drive from Adelaide. [Car Hire](#) Whilst island experiences are included in the tariff, hiring a car can be fun and allows guests to explore Kangaroo Island as they like. Many mainland car hire companies have restrictions regarding their vehicles being driven on Kangaroo Island, and/or boarding the ferry. It's best to check terms with the operator. A good option is to hire a car on the island; [Budget](#) and [Hertz](#) operate both at Kingscote Airport and from the ferry terminal at Penneshaw. For more detailed information view the [Getting There & Away fact sheet](#).

Transfers

The Lodge operates transfers with fellow guests connecting with scheduled flights included in the tariff. Private transfers are available at additional cost and are required for connections with charter flights. Pre or post private touring is also an excellent transfer option.

Children

Southern Ocean Lodge welcomes children ten years and over.

What to Bring

Dress is smart casual at Southern Ocean Lodge and feeling relaxed is key. No matter when the stay, bring comfortable walking shoes, a warm top and a rain jacket. In the cooler months, it's best to pack clothing that can be layered for versatility. Hat, camera, sunscreen and a keen sense of adventure are a must!

Luxury Lodges of Australia

Southern Ocean Lodge is honoured as a founding member of [Luxury Lodges of Australia](#), celebrating a new era of Australian experiential luxury accommodation and adventure.

Lodge Contacts

Southern Ocean Lodge

Hanson Bay, Kangaroo Island SA 5223

T 61 8 8559 7347

F 61 8 8559 7350

E reception@southernoceanlodge.com.au